

Revisions					
Rev	Description	Zone	Date	Drawn	Checked

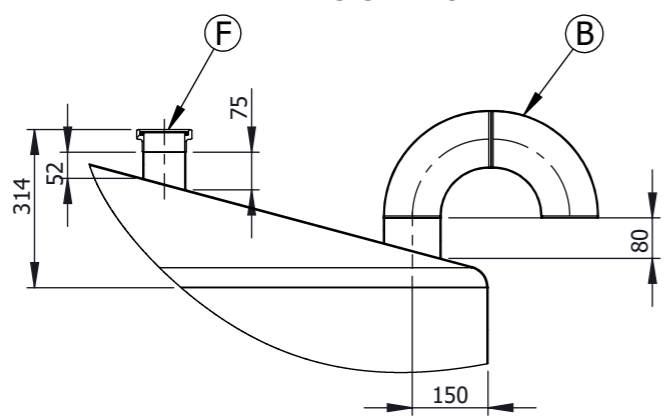
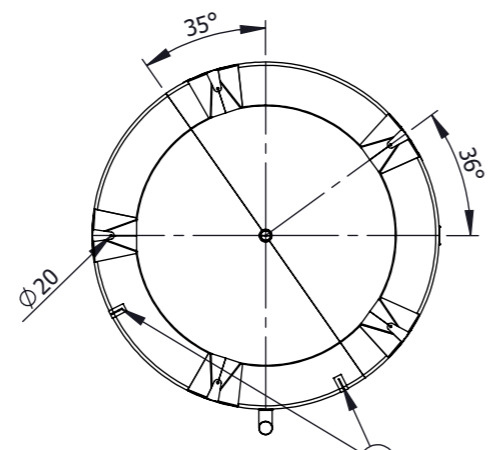
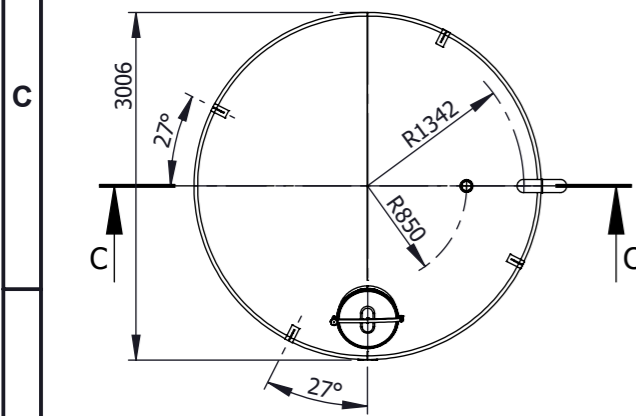
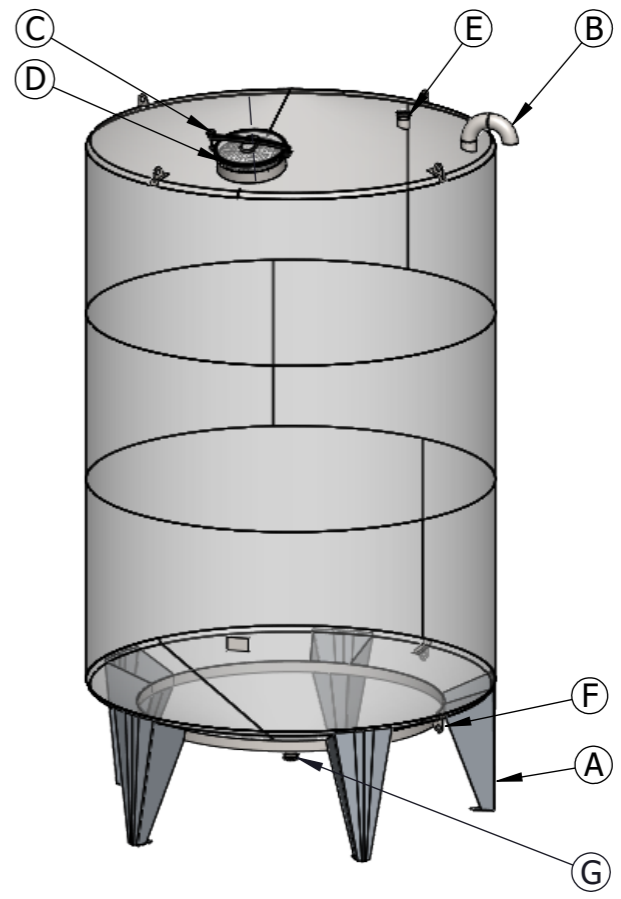
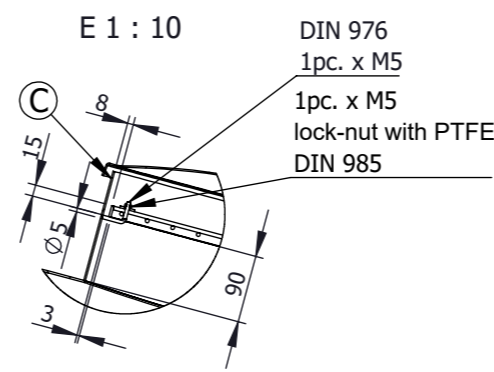
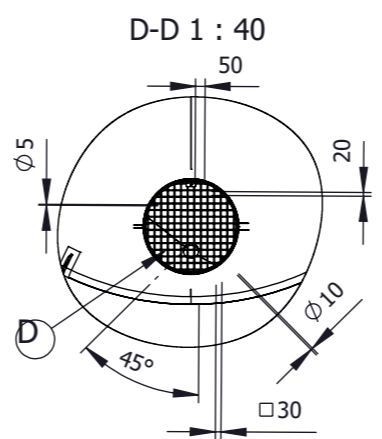
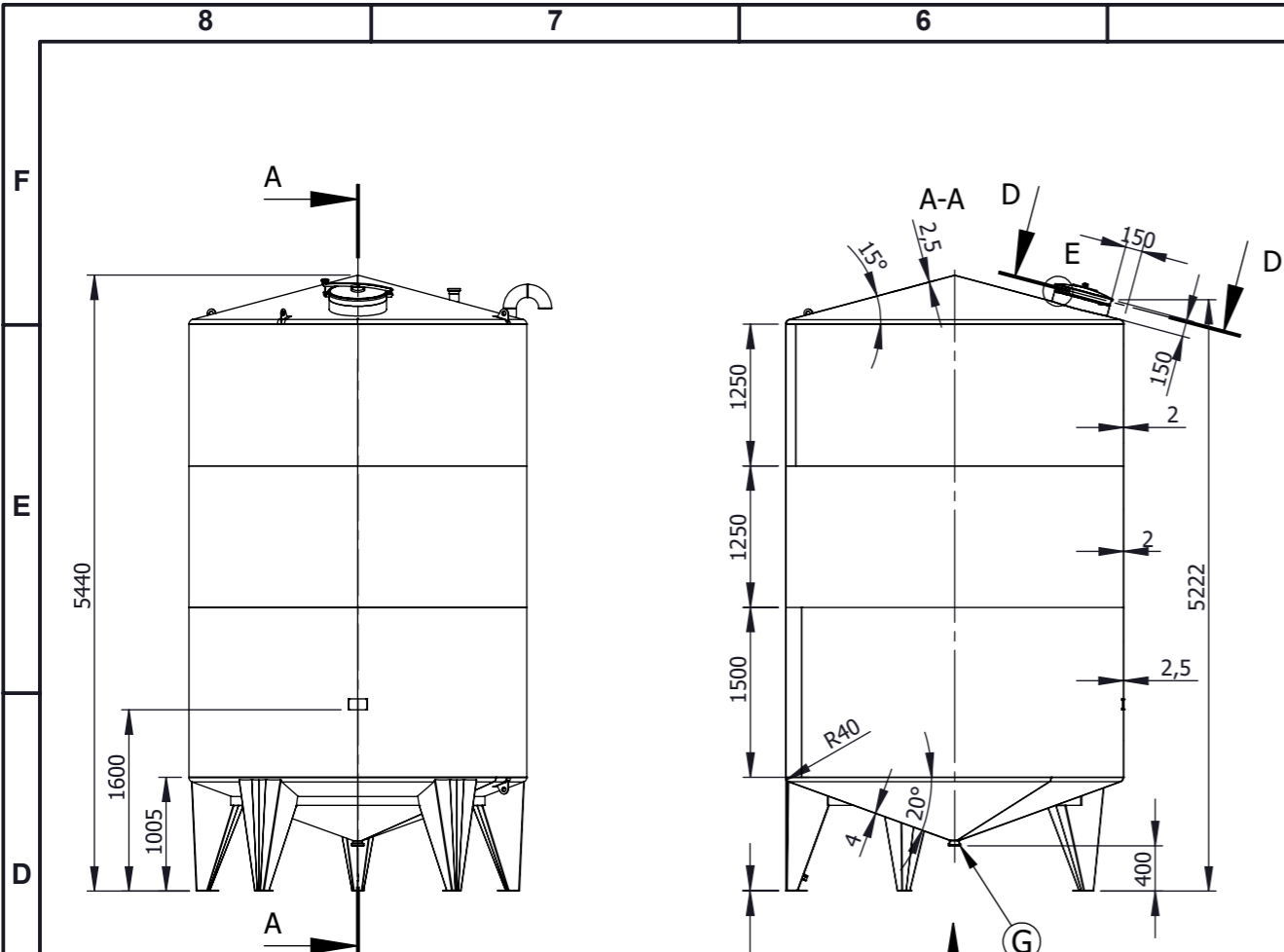

Behälter KG Bremen GmbH & Co.  
Theodor-Barth-Str. 25  
28307 Bremen - Germany  
Tel. +49 (0) 421 34 85 114  
E-Mail: mail@behaelter-kg.de

TYPE K5-SL			
Serial number	119 901 51	Stock nr.	EW11.641V6LN
Geometrical volume	30400 t	Geometrical volume - jacket	-
Working pressure	Atmospheric	Working pressure - jacket	-
Working temperature	-10/80°C	Working temperature - jacket	-
Maximum density	1,2 kg/dm³	Jacket pressure drop	-
Tare mass	1193 kg	Material	1.4404 / AISI 316L
Equipment output/voltage	-	Year of manufacture	-

Item	Description	PN bar	DN mm.	Qty.
A	LEG ON BASE PLATE	-	-	5
B	AIR VENT DN100 ON TANK WITH 2 x BENDS 114.3x2	atm.	100	1
C	UPPER MANHOLE DN500 Elica art.50/1p-6 EPDM-FDA GASKET	atm.	500	1
D	SAFETY GRID FOR UPPER MANHOLE DN500	-	-	1
E	INLET DN80 ON TANK TOP UP TO WELDING MALE DN80 DIN 11851	atm.	80	1
F	LIFTING LUG ON TANK BOTTOM	-	-	2
G	TOTAL OUTLET DN80 ON TANK BOTTOM UP TO WELDING MALE DN80 DIN 11851	atm.	80	1

Straightness, flatness and parallelism - EN 13920 F								Linear dimensions - EN 13920 B									
≥30	>120	>400	>1000	>2000	>4000	>8000	>12000	≥2	>30	>400	>1000	>2000	>4000	>8000	>12000		
≤120	≤400	≤1000	≤2000	≤4000	≤8000	≤12000	≤16000	≤30	≤400	≤1000	≤2000	≤4000	≤8000	≤12000	≤16000		
1	1.5	3	4.5	6	8	10	12	±1	±2	±3	±4	±6	±8	±10	±12		
Surface	Outside				Matt 2B				Weld. seams	Outside				Strip grinded 2x20 Ra<1,6			
	Inside				Matt 2B					Inside				Flat grinded to Ra<0,8			

1.6	Drawn: K.N.	Scale 1:65	Weight 1193	1.4404 AISI 316L	119 901 51 EW11.641V6LN
Checked: K.I.	TYPE K5-SL-30400L				
Approved: D.M.	Rev 6.6.2019 r.	Lang Eng	Sheet 1/1		