

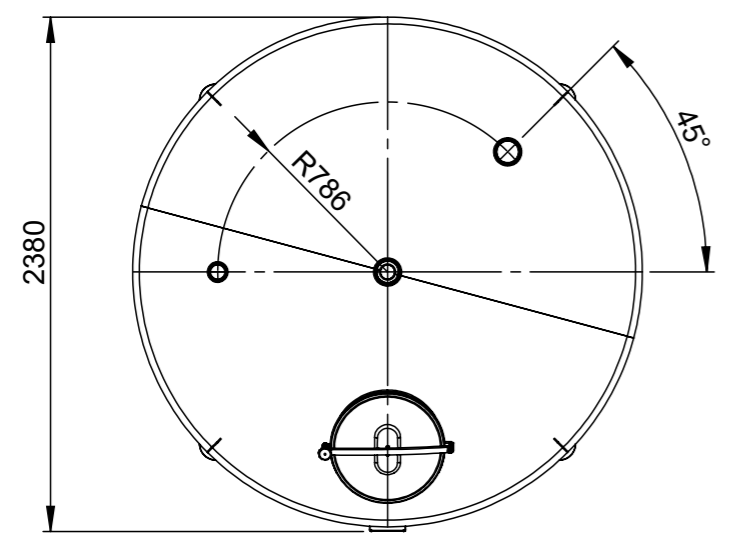

Behälter KG Bremen GmbH & Co.
 Theodor-Barth-Str. 25
 28307 Bremen - Germany
 Tel. +49 (0) 421 34 85 114
 E-Mail: mail@behaeltes-kg.de

Revisions

Rev	Description	Zone	Date	Drawn	Checked
A	Remove the elliptical manhole. Change the name of the tank. Change stock numbers.		03.09.18		

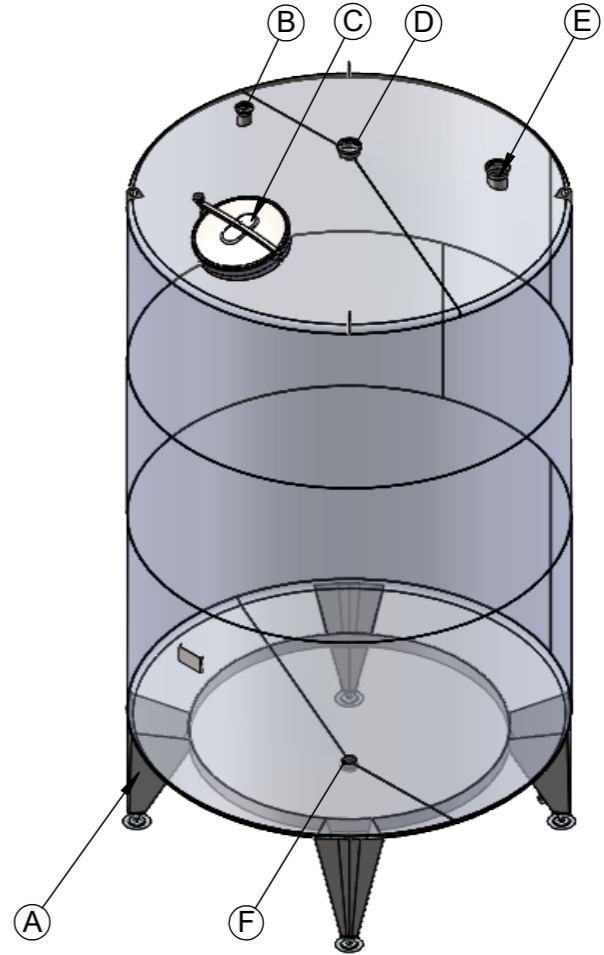
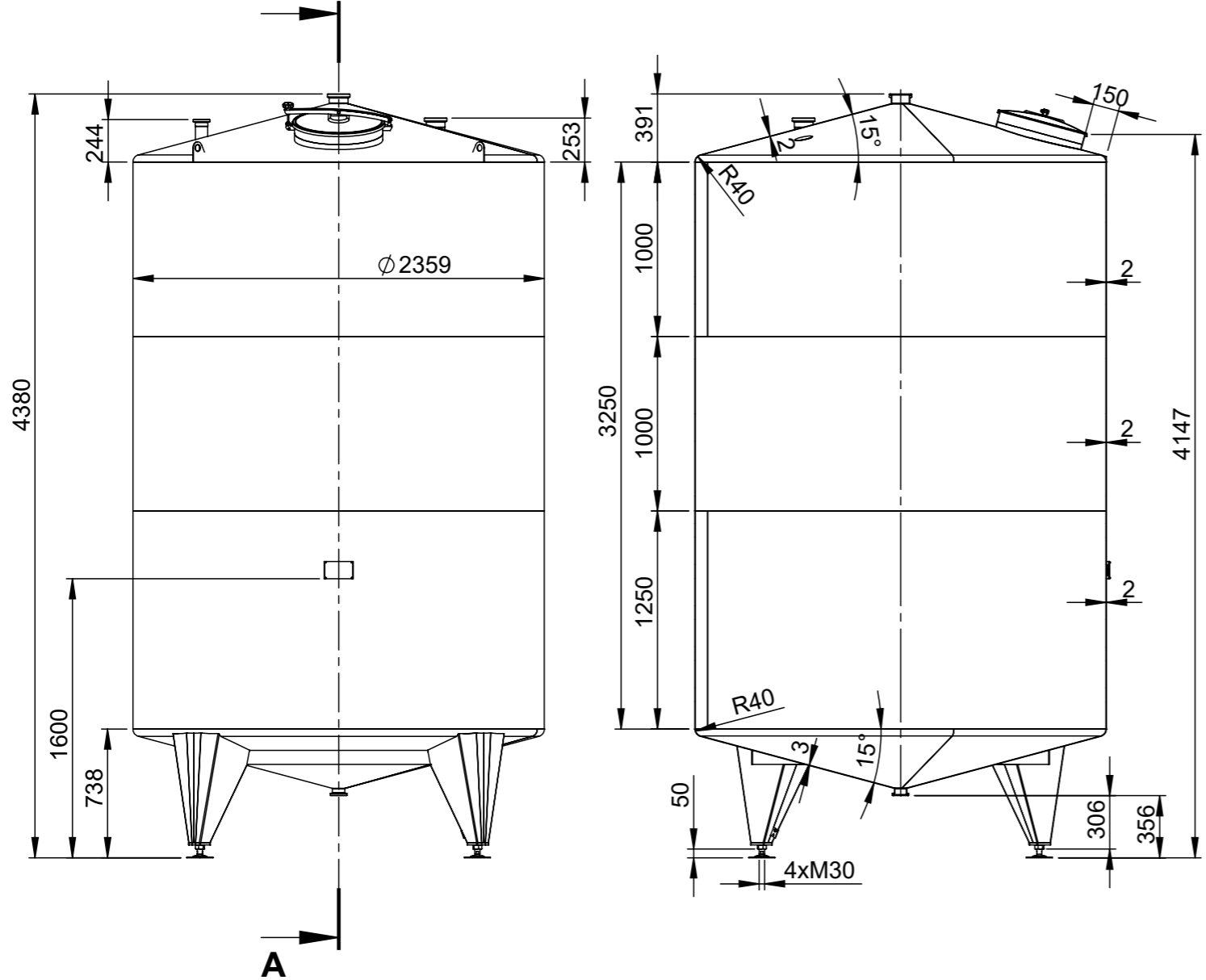

TYPE K3-SL	
Serial number	118 142 12 01
Geometrical volume	15300 l
Working pressure	Atmospheric
Working temperature	-10/80°C
Maximum density	1.2kg/dm³
Tare mass	647 kg
Equipment output/voltage	-
Stock nr.	EW11.337V6LN / ID16.330
Geometrical volume - jacket	-
Working pressure - jacket	-
Working temperature - jacket	-
Jacket pressure drop	-
Material	1.4404/AISI 316L
Year of manufacture	-

Item	Description	PN bar	DN mm.	Qty.
A	LEG ON ADJUSTABLE SUPPORT	-	-	4
B	INLET DN65 ON TANK TOP UP TO WELDING MALE DN65 DIN11851	atm.	65	1
C	UPPER MANHOLE DN500 Elica art.50/1p-6 WITH EPDM-FDA-GASKET	atm.	500	1
D	INLET DN100 CENTRICALLY MOUNTED ON TANK TOP UP TO WELDING MALE DN100 DIN11851	atm.	100	1
E	INLET AIRVENT DN100 ON TANK TOP UP TO WELDING MALE DN100 DIN11851	atm.	100	1
F	TOTAL OUTLET DN65 UP TO WELDING MALE DN65 DIN11851	atm.	65	1

Straightness, flatness and parallelism - EN 13920 F								Linear dimensions - EN 13920 B							
≥30	>120	>400	>1000	>2000	>4000	>8000	>12000	≥2	>30	>400	>1000	>2000	>4000	>8000	>12000
≤120	≤400	≤1000	≤2000	≤4000	≤8000	≤12000	≤16000	≤30	≤400	≤1000	≤2000	≤4000	≤8000	≤12000	≤16000
1	1.5	3	4.5	6	8	10	12	±1	±2	±3	±4	±6	±8	±10	±12

Surface	Outside	Matt 2B	Weld. seams	Outside	Strip grinded 2x20 Ra<1.6
	Inside	Matt 2B		Inside	Strip grinded 2x20 Ra<1.6

1.6	Drawn: C.A.	Scale 1:35	Weight 647	118 142 12
	Checked: K.I.			EW11.337V6LN / ID16.330
	Approved: D.M.			TYPE K3-SL-15300L

Rev	4.9.2018 r.	Lang Eng	Sheet 1/1
-----	-------------	----------	-----------